

REVISIONS			

- NOTES**
- SL and SR wings are exposed, only blocked by the few wood planks.
 - The ground cloth needs to be attached to the stage floor.
 - All furniture and props are free moving and placements on the plot are place holders.

SET DESIGN BY
ASH NEECE
 814-785-4370 CEASHLEYNEECE@GMAIL.COM

TECHNICAL DIRECTION: BOBBY JULGA
 SCENE PAINTING: MACHELLA BROCK

THE DRAWINGS AND INFORMATION CONTAINED HEREIN REPRESENT VISUAL CONCEPTS AND CONSTRUCTION SUGGESTIONS ONLY. THE DESIGNER IS UNQUALIFIED TO DETERMINE THE STRUCTURAL APPROPRIATENESS OF THIS DESIGN AND WILL NOT ASSUME RESPONSIBILITY FOR IMPROPER ENGINEERING, ELECTRIFICATION, CONSTRUCTION HANDLING, OR USE OF THE SYSTEM. ALL MATERIALS, CONSTRUCTION, AND WIRING THROUGHOUT SHALL COMPLY WITH THE MOST STRINGENT OF FEDERAL, STATE, AND LOCAL FIRE AND SAFETY CODES.

MUD

VENUE: STAGE III
 SCALE: 1/2" = 1'-0"

FRONT VIEW

II OF
 PLATE

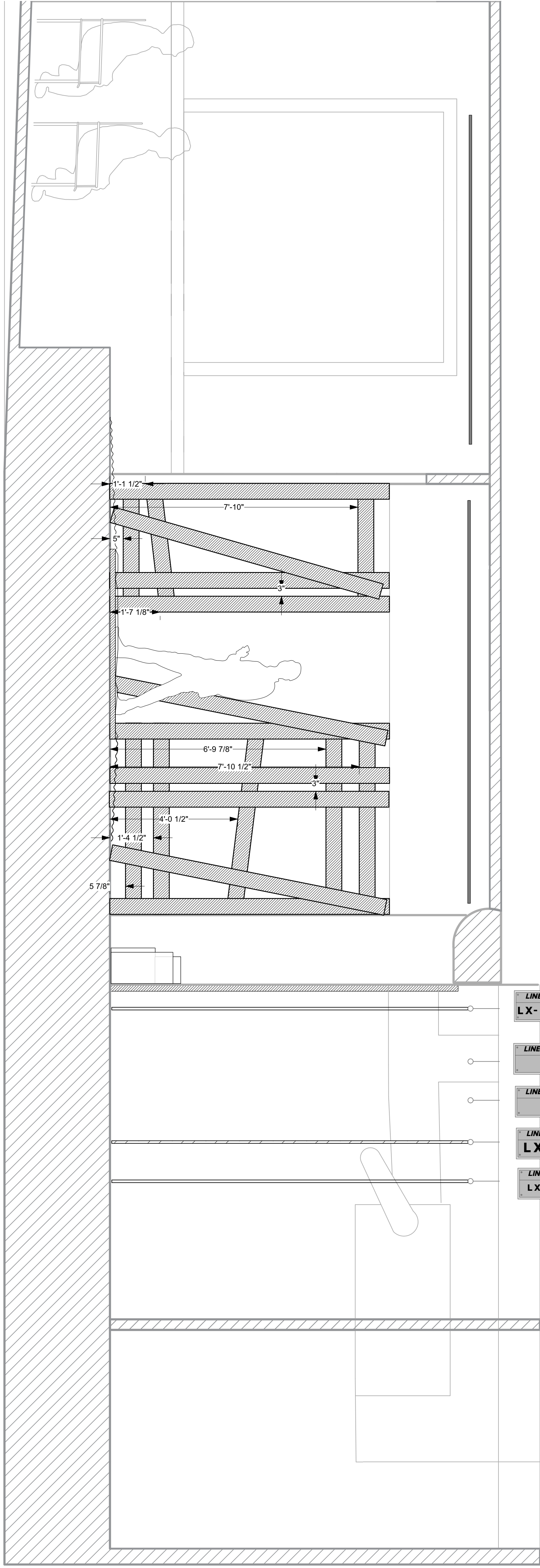

- LINESET 1 // TRIM: +11'-4"
LX-5 / TRAVLER
- LINESET 4 // TRIM: +11'-4"
LX-6
- LINESET 4 // TRIM: +11'-4"
LX-7
- LINESET 2 // TRIM: +11'-4"
LX-8 / CYC
- LINESET 3 // TRIM: +11'-4"
LX-9 / MASKING

REVISIONS			

NOTES

- SL and SR wings are exposed, only blocked by the few wood planks.
- The ground cloth needs to be attached to the stage floor.
- All furniture and props are free moving and placements on the plot are place holders.

SET DESIGN BY
ASH NEECE
214-795-4370 CEASHLEYNEECE@GMAIL.COM

TECHNICAL DIRECTION: BOBBY JULGA
SCENE PAINTING: MACHEALA BROCK

THE DRAWINGS AND INFORMATION CONTAINED HEREIN REPRESENT VISUAL CONCEPTS AND CONSTRUCTION SUGGESTIONS ONLY. THE DESIGNER IS UNQUALIFIED TO DETERMINE THE STRUCTURAL APPROPRIATENESS OF THIS DESIGN AND WILL NOT ASSUME RESPONSIBILITY FOR IMPROPER ENGINEERING, ELECTRIFICATION, CONSTRUCTION HANDLING, OR USE OF THIS SYSTEM. ALL MATERIALS, CONSTRUCTION, AND WIRING THROUGHOUT SHALL COMPLY WITH THE MOST STRINGENT OF FEDERAL, STATE, AND LOCAL FIRE AND SAFETY CODES.



VENUE: STAGE III
SCALE: 1/2" = 1'-0"
SR SECTION

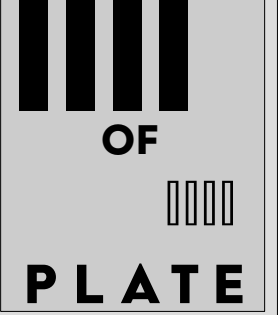

FRONT VIEW - FRAME

Scale: 0'-3/4" = 1'-0"

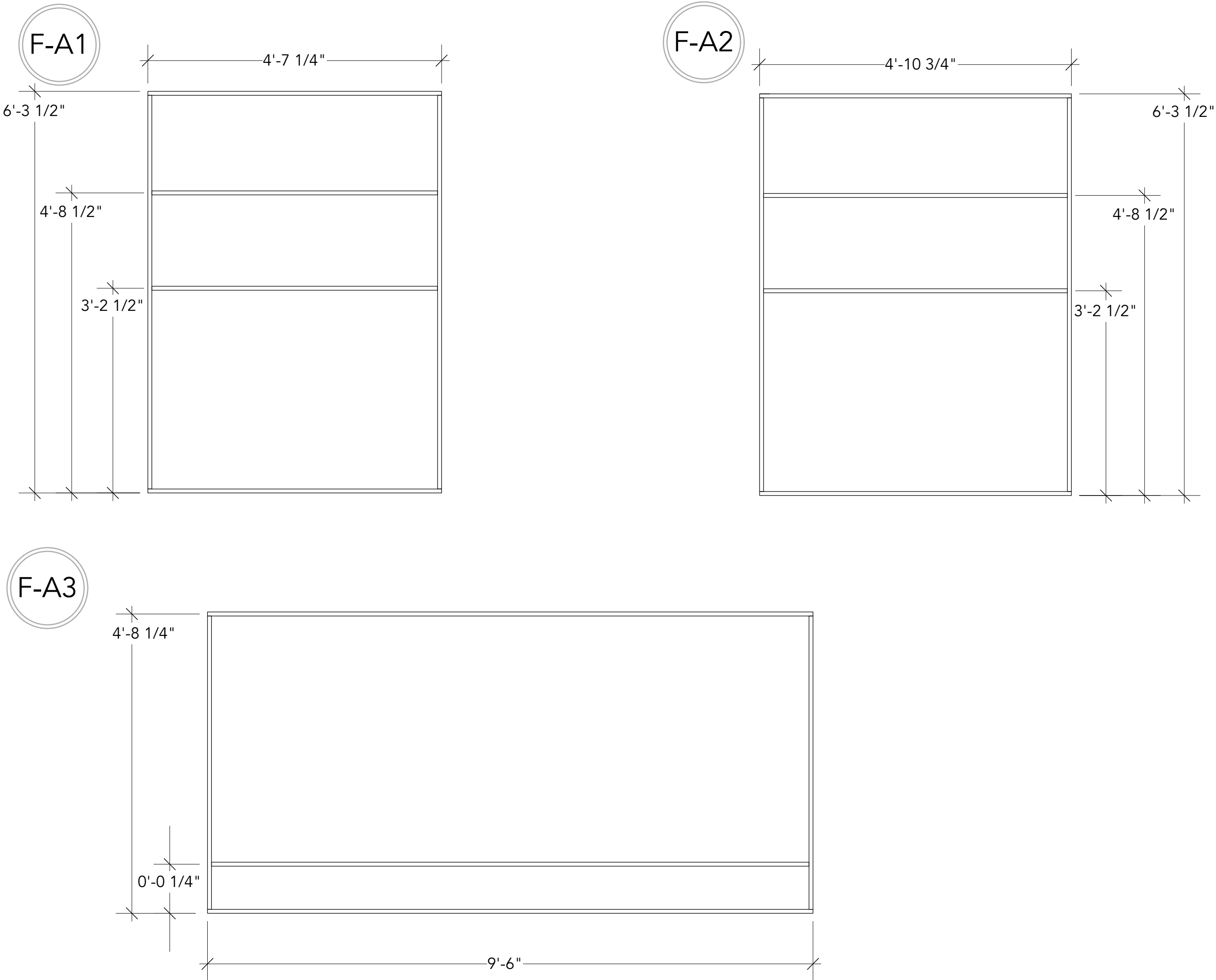

FRONT VIEW - SLAT LAYOUT

Scale: 0'-3/4" = 1'-0"

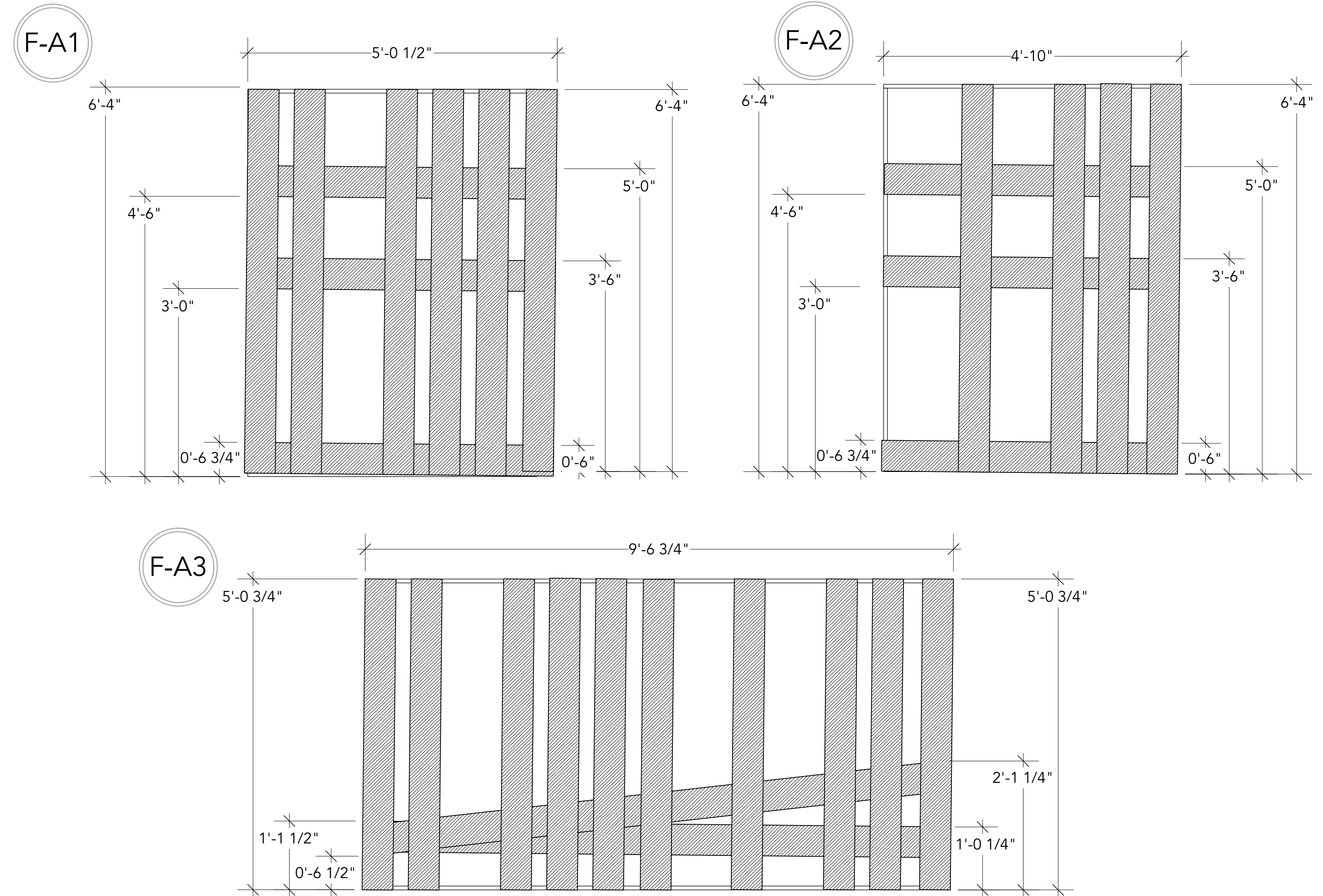

FRONT VIEW - FRAME COMPOSITE

Scale: 0'-1/2" = 1'-0"

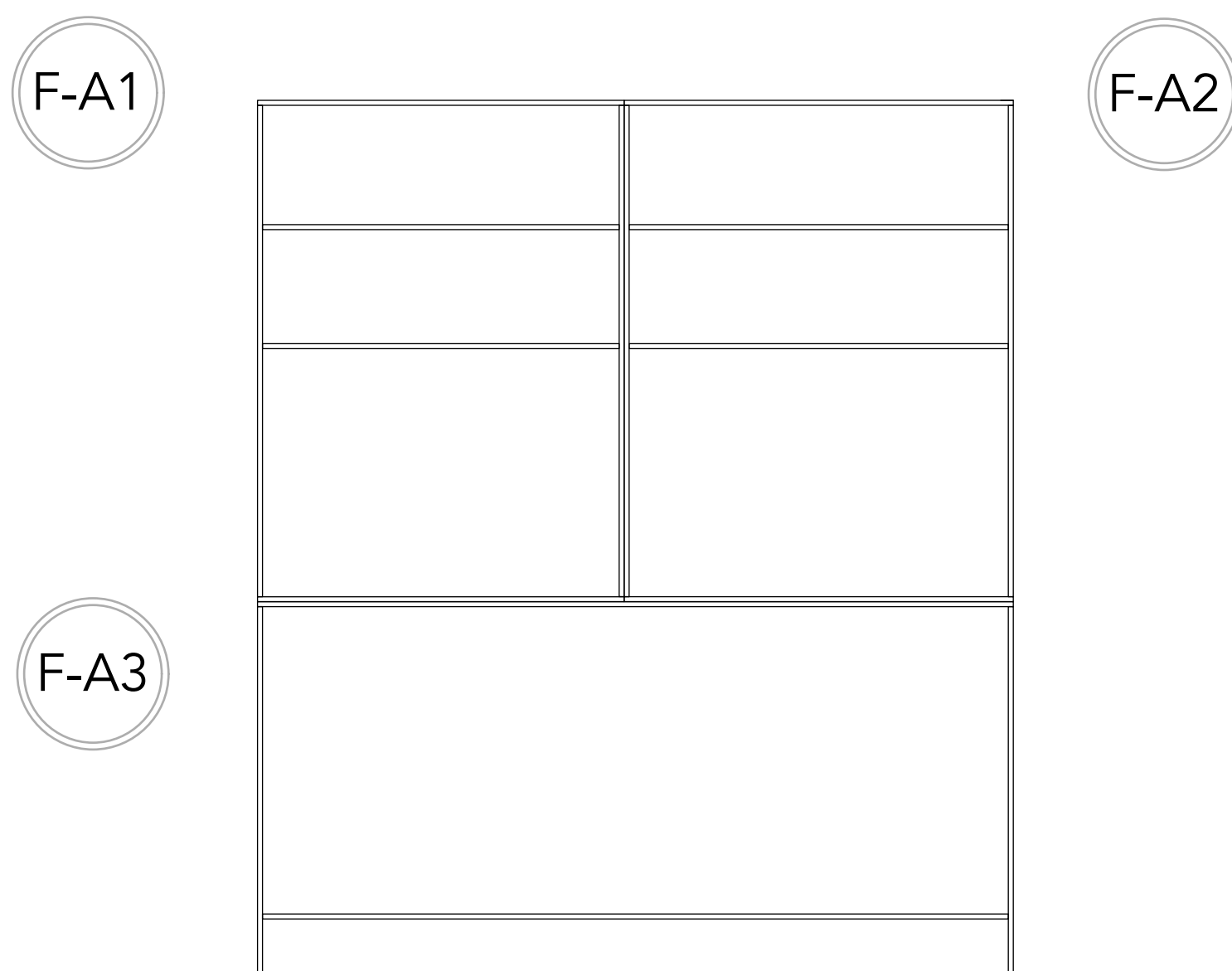

FRONT VIEW - SLAT COMPOSITE

Scale: 0'-1/2" = 1'-0"

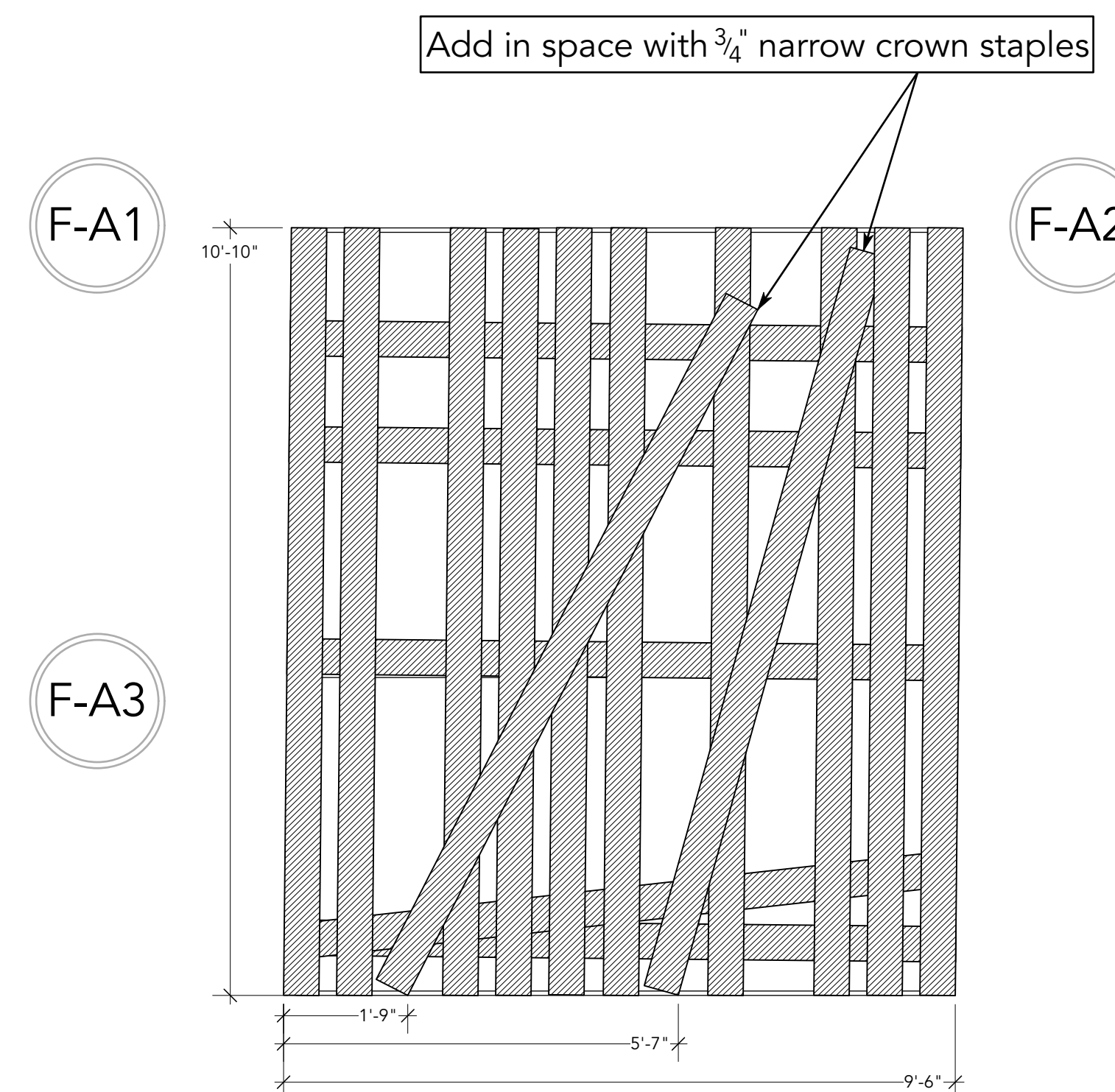

NOTES:

- 1x4 flats, Hollywood style
- Assemble w/ glue and 1 1/2" narrow crown staples
- Face w/ 6" strips of 1/4" MDF
- Attach facing w/ glue and 3/4" narrow crown staples
- 1X4 Cross Brace for travel



MUD

SR UPSTAGE WALL

DIRECTOR : NATHAN SHU

TD : BOBBY JULGA

DESIGNER : ASH NEECE

ATD : ERIN RILEY

REVISIONS

1/28 - Prelim
2/2 - Space Adjustments
2/4 - Space Adjustments
2/5 - Final

SCALE:
Various

P-1

FRONT VIEW - FRAME

Scale: 0'-3/4" = 1'-0"

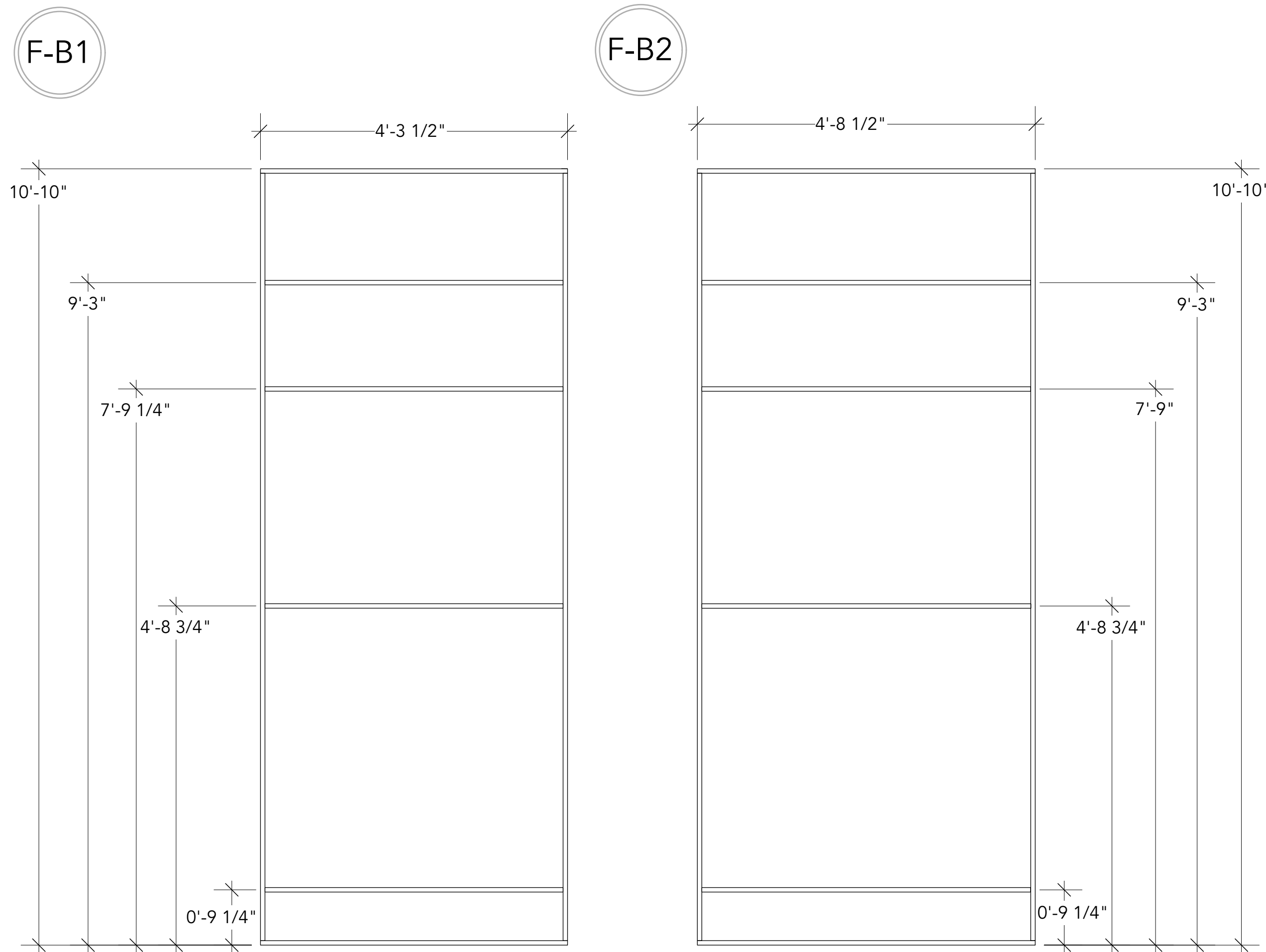

FRONT VIEW - SLAT LAYOUT

Scale: 0'-3/4" = 1'-0"

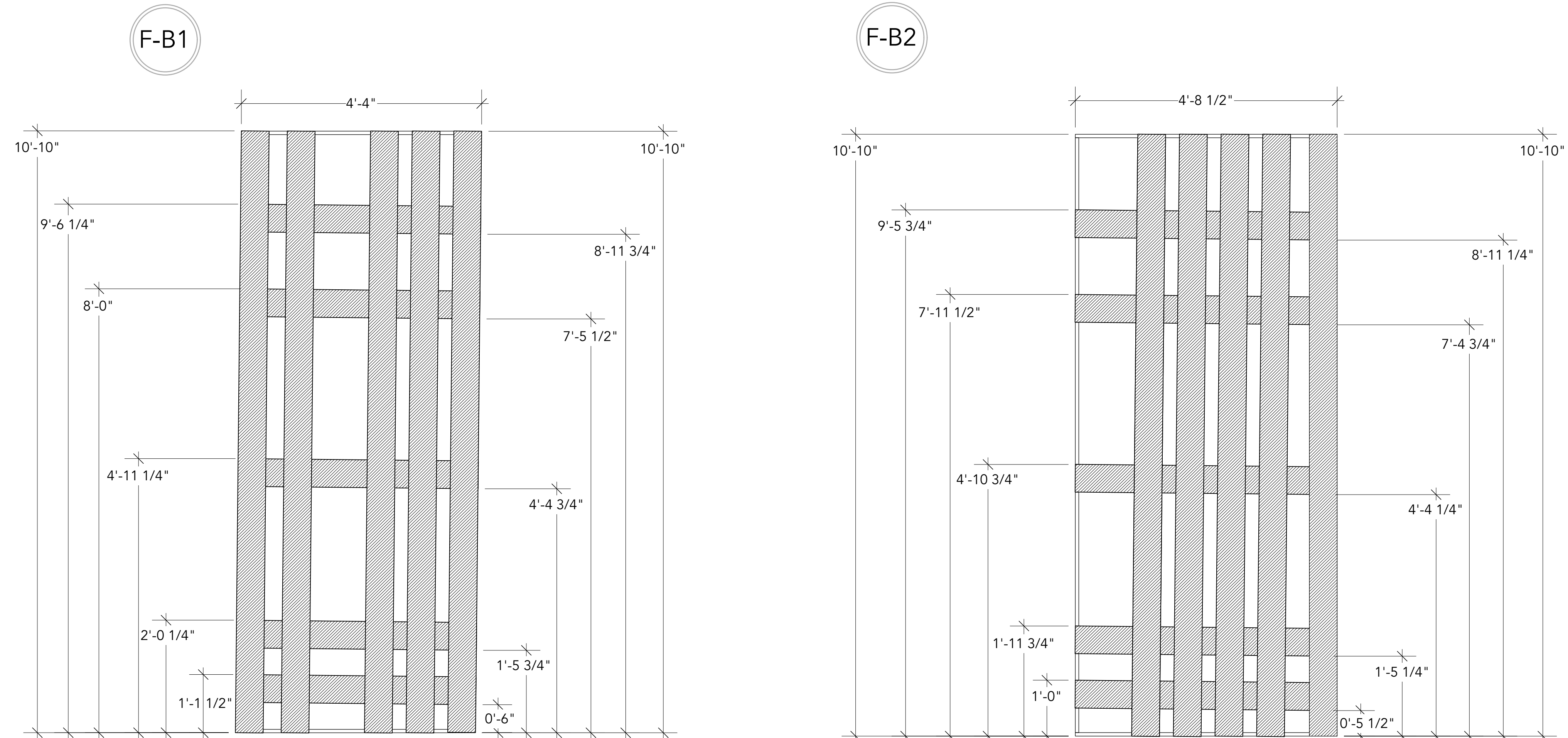

FRONT VIEW - FRAME COMPOSITE

Scale: 0'-1/2" = 1'-0"

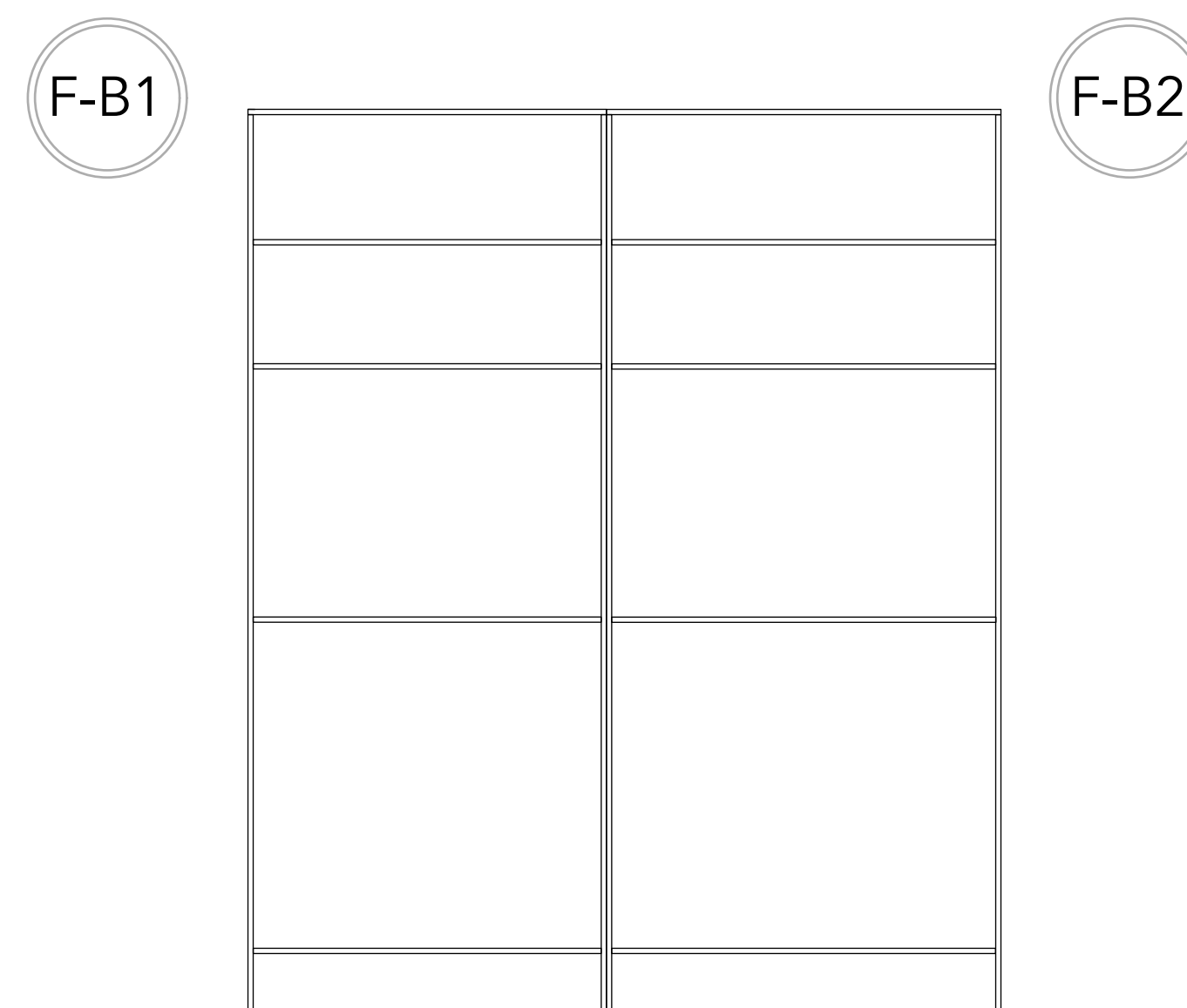

FRONT VIEW - SLAT COMPOSITE

Scale: 0'-1/2" = 1'-0"

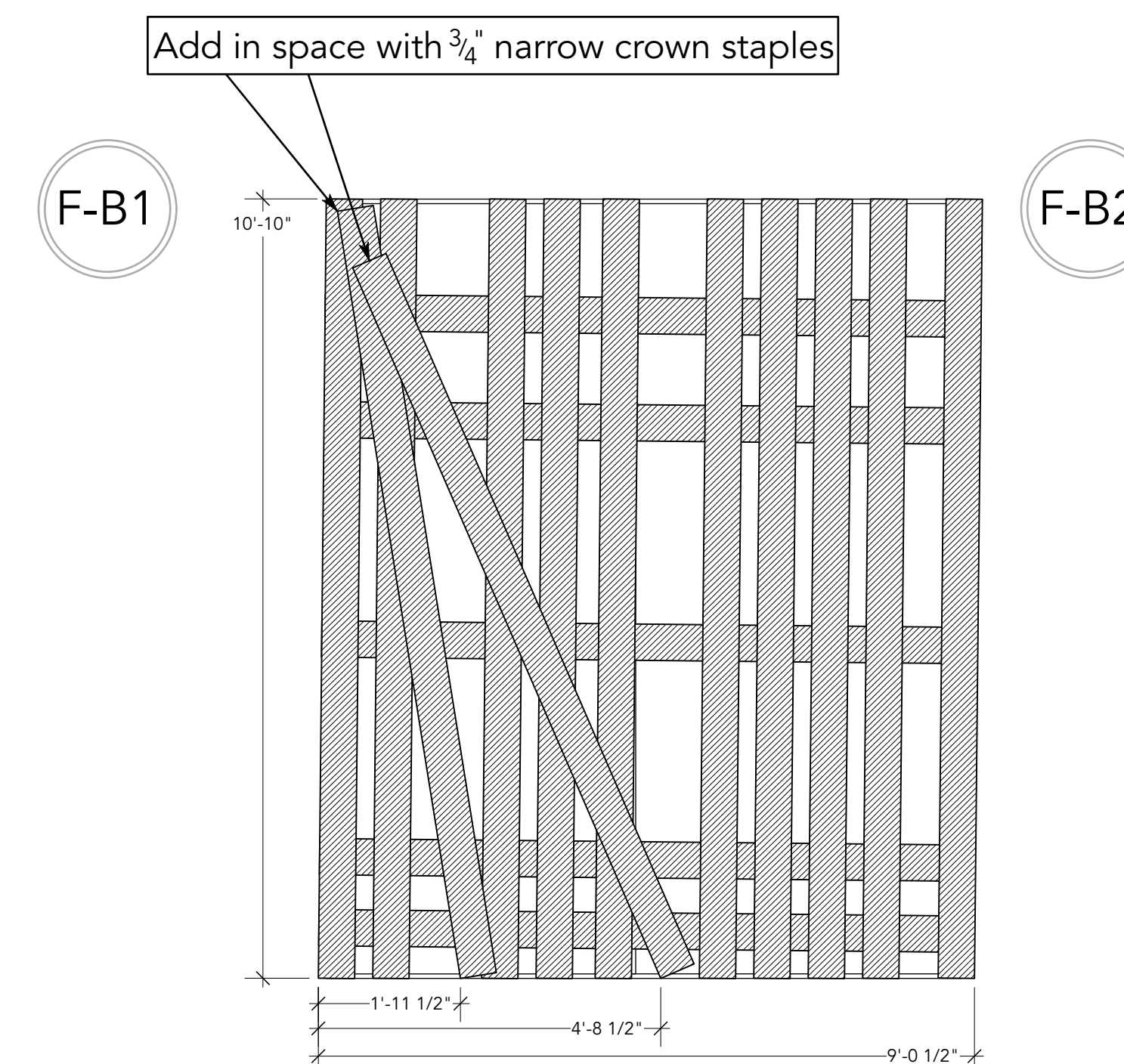

NOTES:

- ▣ 1x4 flats, Hollywood style
- ▣ Assemble w/ glue and 1 1/2" narrow crown staples
- ▣ Face w/ 6" strips of 1/4" MDF
- ▣ Attach facing w/ glue and 3/4" narrow crown staples
- ▣ 1X4 Cross Brace for travel



MUD

SL UPSTAGE WALL

DIRECTOR : NATHAN SHU

TD : BOBBY JULGA

DESIGNER : ASH NEECE

ATD : ERIN RILEY

REVISIONS

1/28 - Prelim
2/2 - Space Adjustments
2/4 - Space Adjustments
2/5 - Final

SCALE:
Various

P-2

FRONT VIEW - FRAME

Scale: 0'-3/4" = 1'-0"

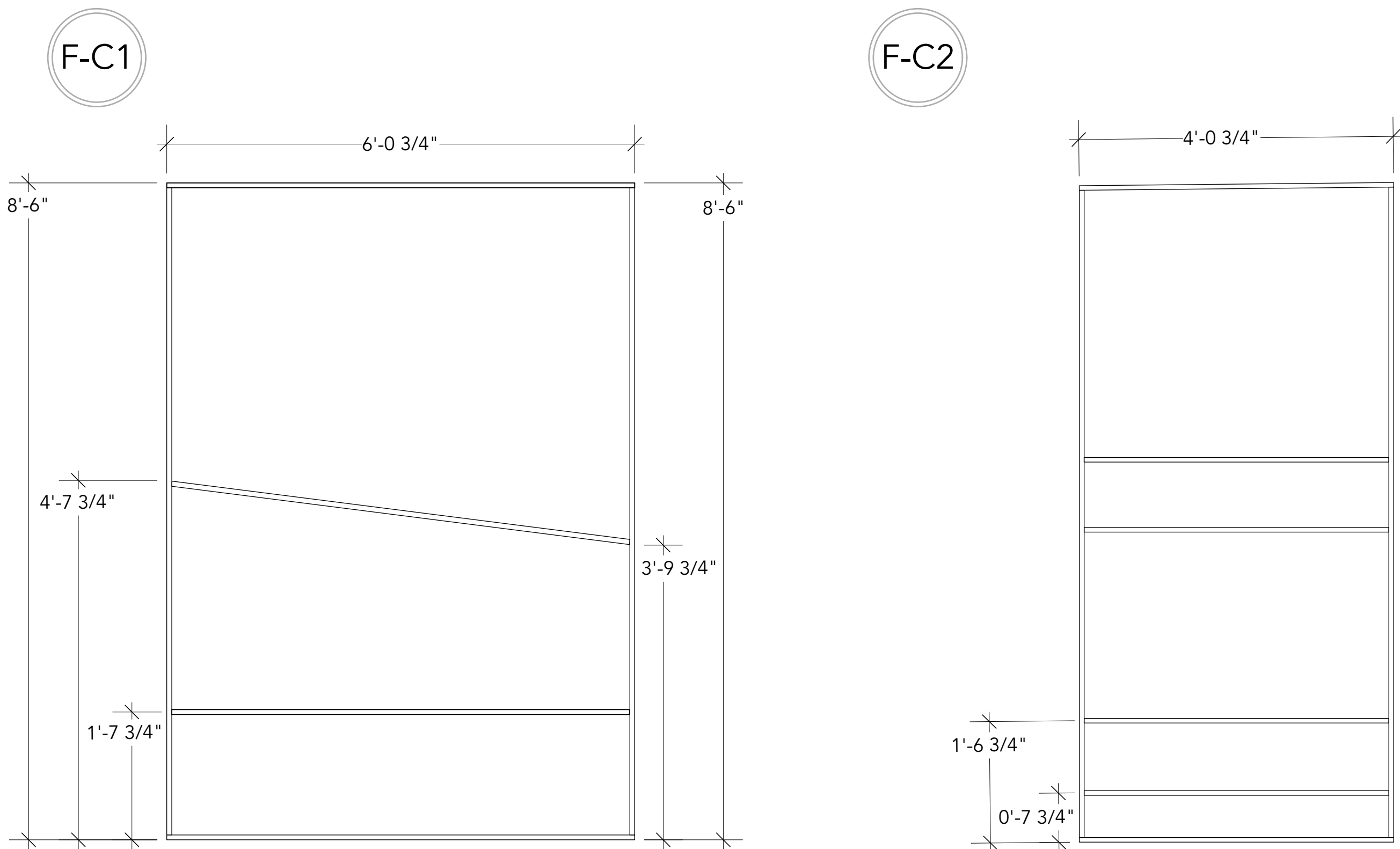

FRONT VIEW - SLAT LAYOUT

Scale: 0'-3/4" = 1'-0"

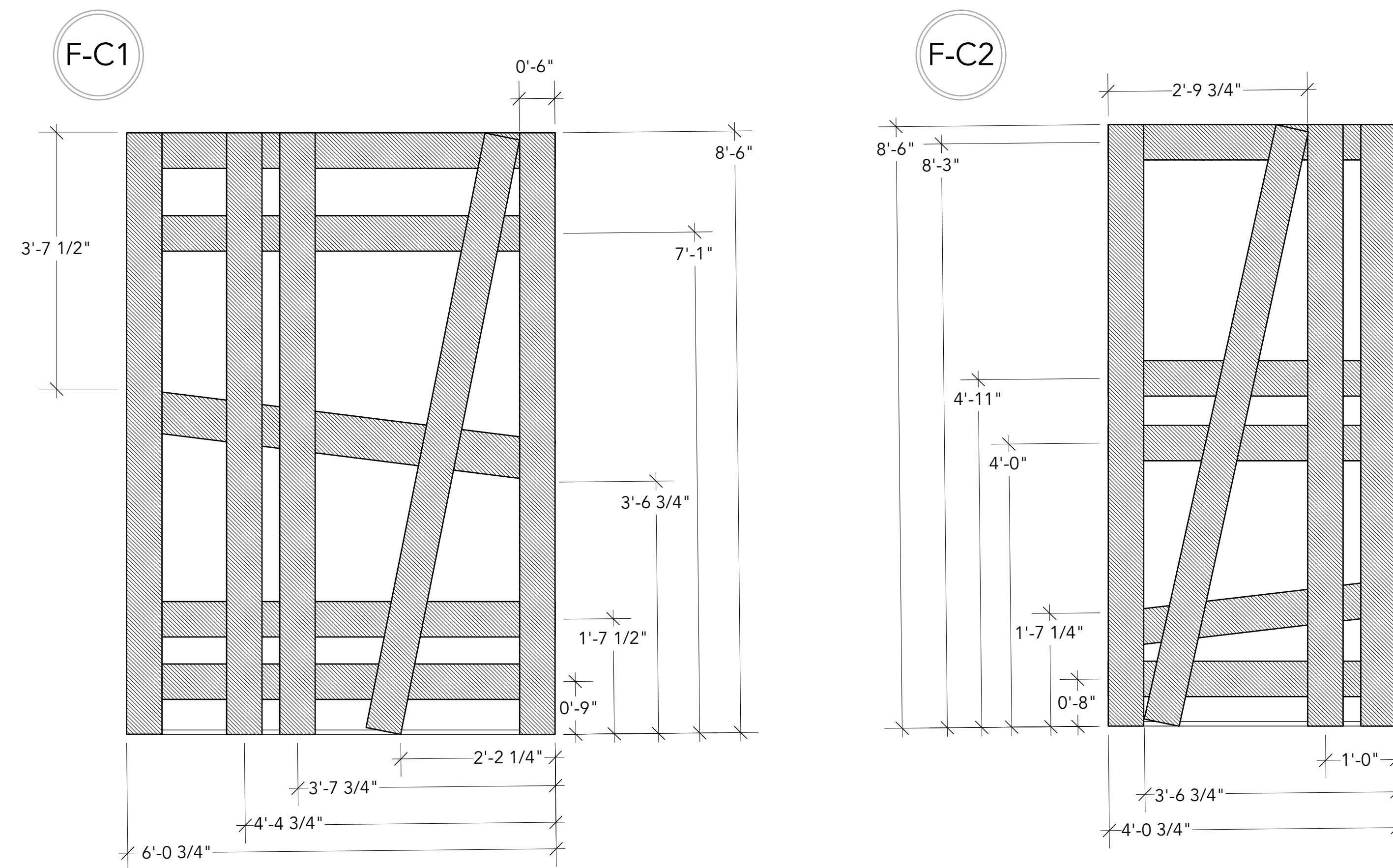

FRONT VIEW - FRAME COMPOSITE

Scale: 0'-1/2" = 1'-0"

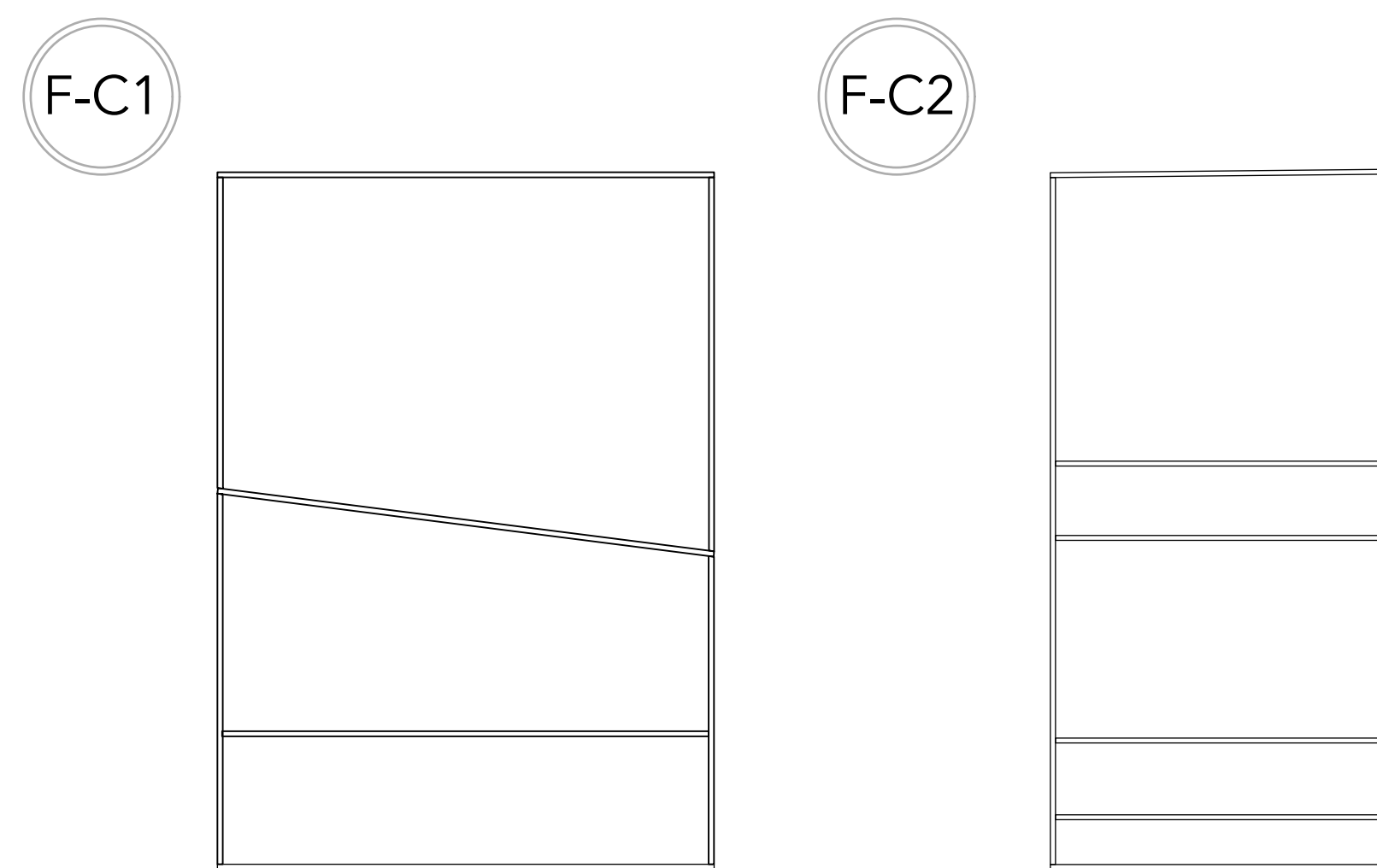

FRONT VIEW - SLAT COMPOSITE

Scale: 0'-1/2" = 1'-0"

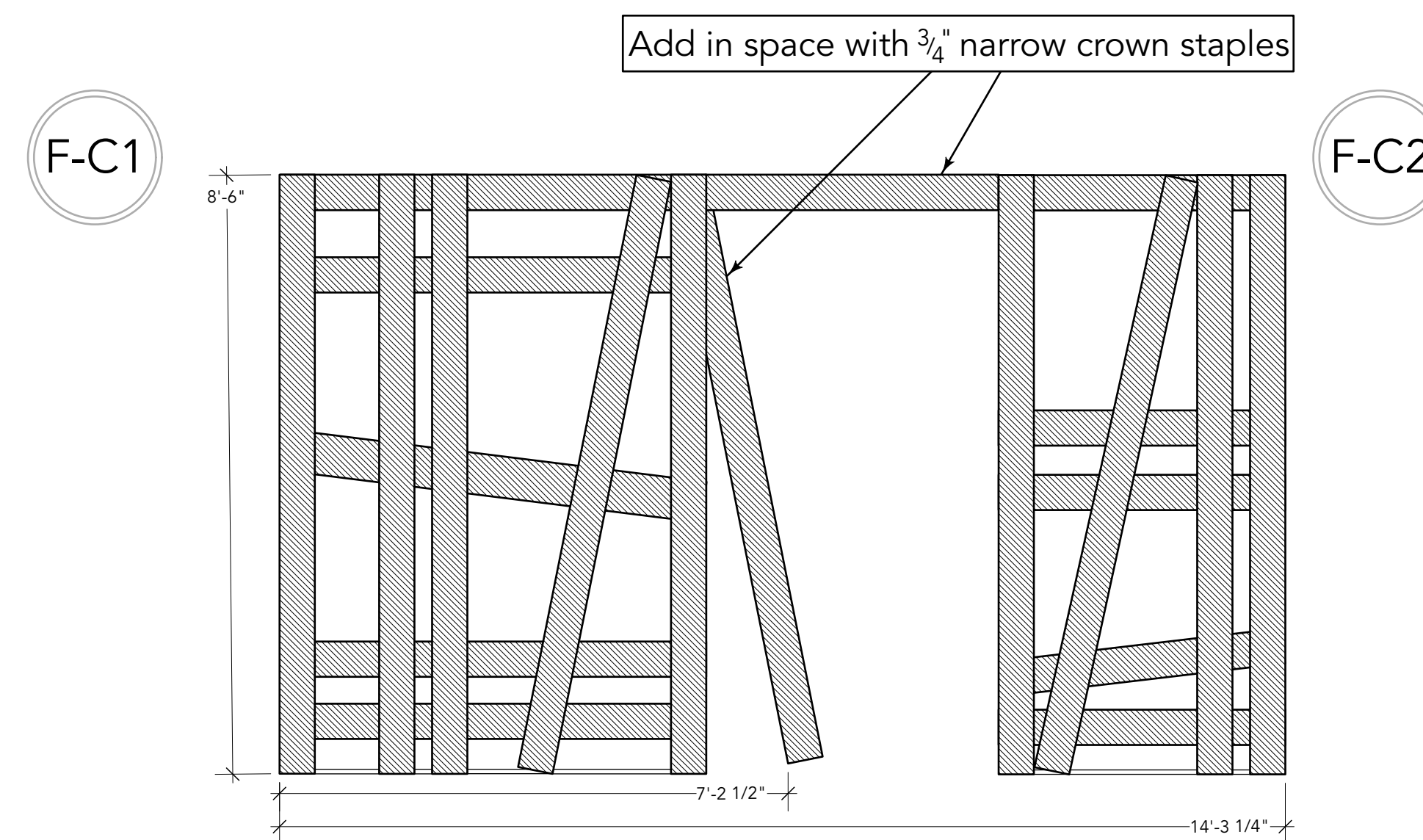

NOTES:

- 1x4 flats, Hollywood style
- Assemble w/ glue and 1 1/2" narrow crown staples
- Face w/ 6" strips of 1/4" MDF
- Attach facing w/ glue and 3/4" narrow crown staples
- 1X4 Cross Brace for travel



MUD

SL WING

DIRECTOR : NATHAN SHU

TD : BOBBY JULGA

DESIGNER : ASH NEECE

ATD : ERIN RILEY

REVISIONS

1/28 - Prelim
2/2 - Space Adjustments
2/4 - Space Adjustments
2/5 - Final

SCALE:
Various

P-3

FRONT VIEW - FRAME

Scale: 0'-3/4" = 1'-0"

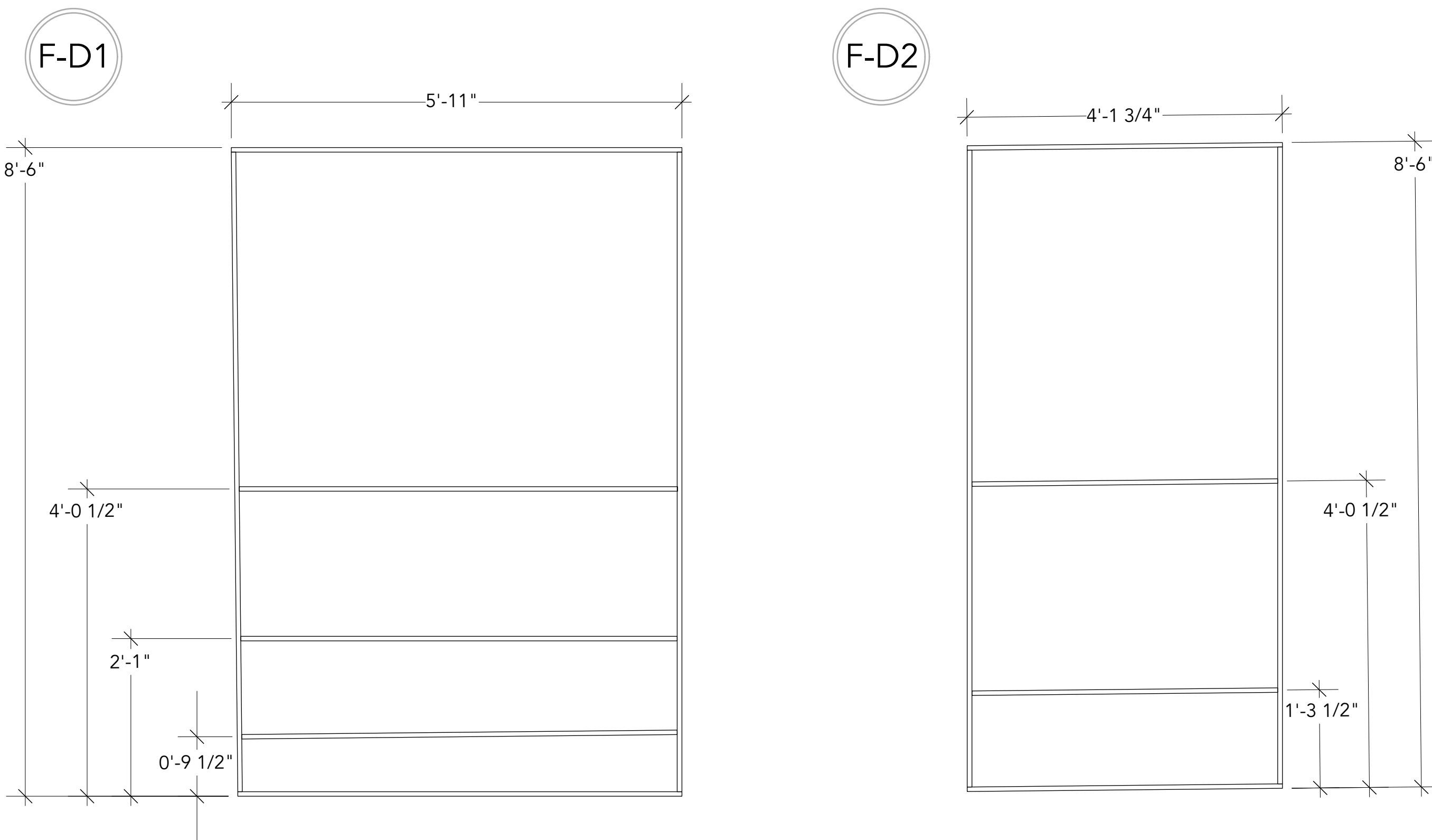

FRONT VIEW - SLAT LAYOUT

Scale: 0'-3/4" = 1'-0"

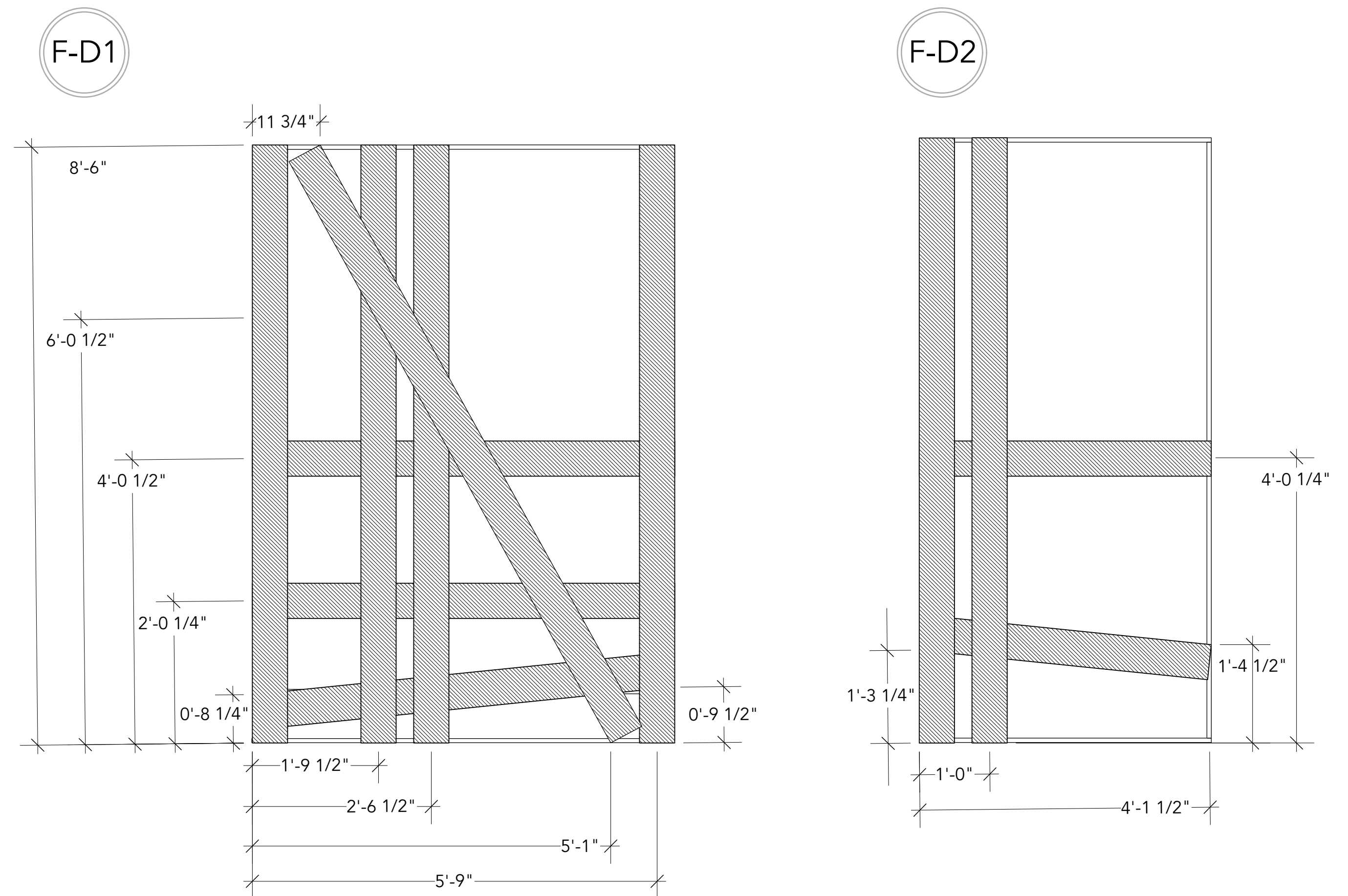

FRONT VIEW - FRAME COMPOSITE

Scale: 0'-1/2" = 1'-0"

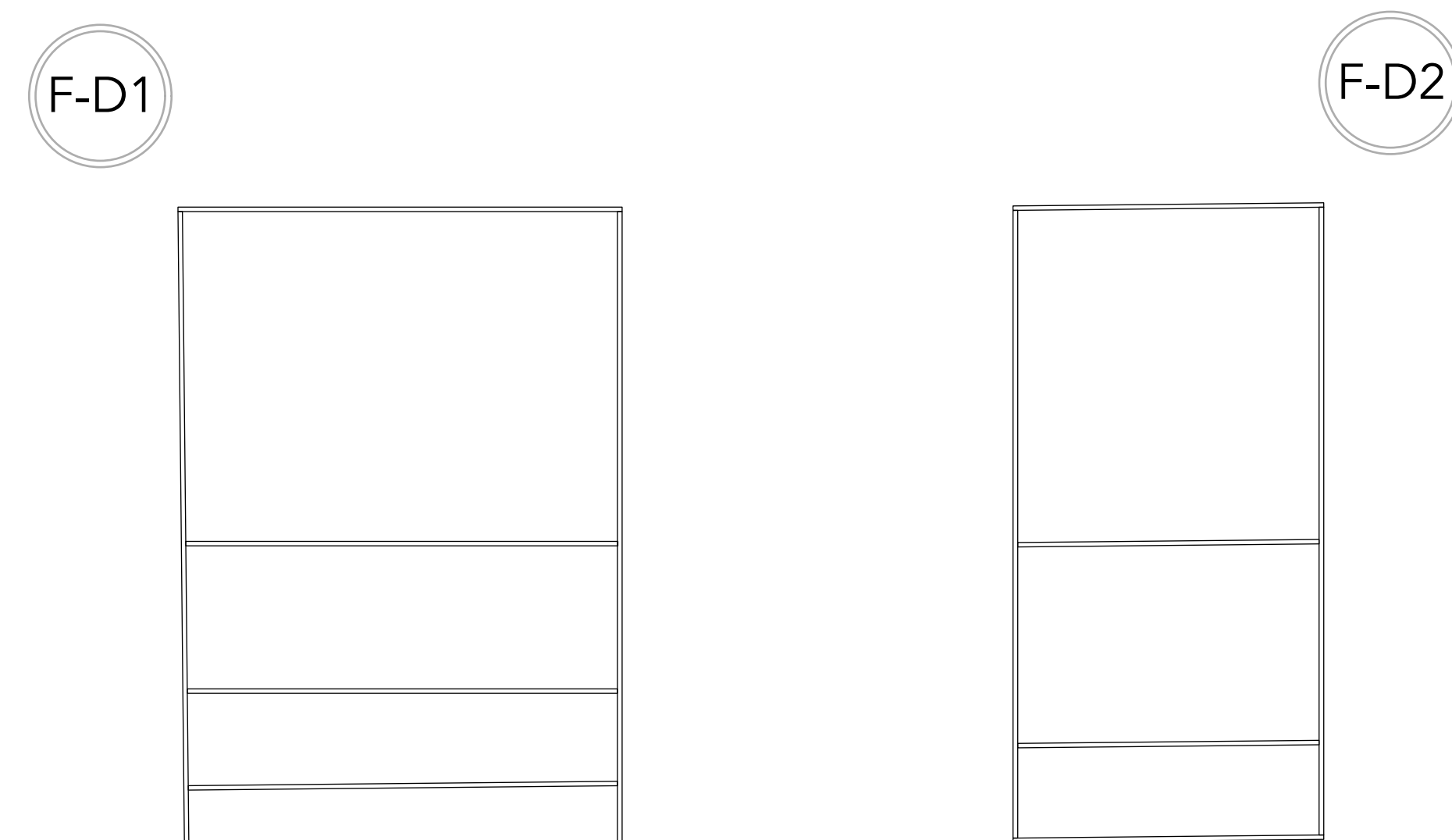

FRONT VIEW - SLAT COMPOSITE

Scale: 0'-1/2" = 1'-0"

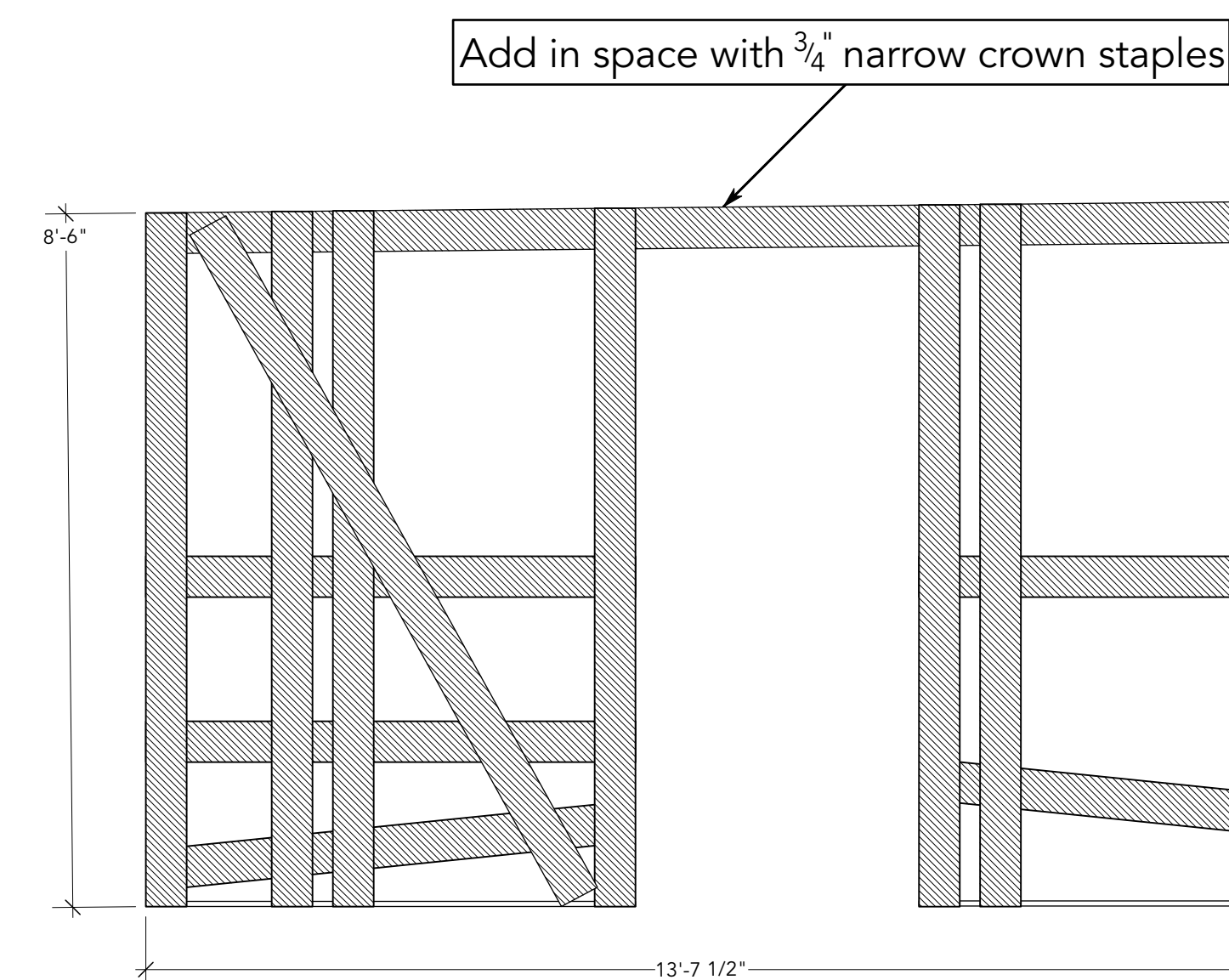

NOTES:

- 1x4 flats, Hollywood style
- Assemble w/ glue and 1 1/2" narrow crown staples
- Face w/ 6" strips of 1/4" MDF
- Attach facing w/ glue and 3/4" narrow crown staples
- 1X4 Cross Brace for travel

	MUD	
	SR WING	
	DIRECTOR : NATHAN SHU	TD : BOBBY JULGA
	DESIGNER : ASH NEECE	ATD : ERIN RILEY
REVISIONS 1/28 - Prelim 2/2 - Space Adjustments 2/4 - Space Adjustments 2/5 - Final	SCALE: Various	P-4